

# Tolley/Brown Layouts & Hall Information

## TOLLEY HALL

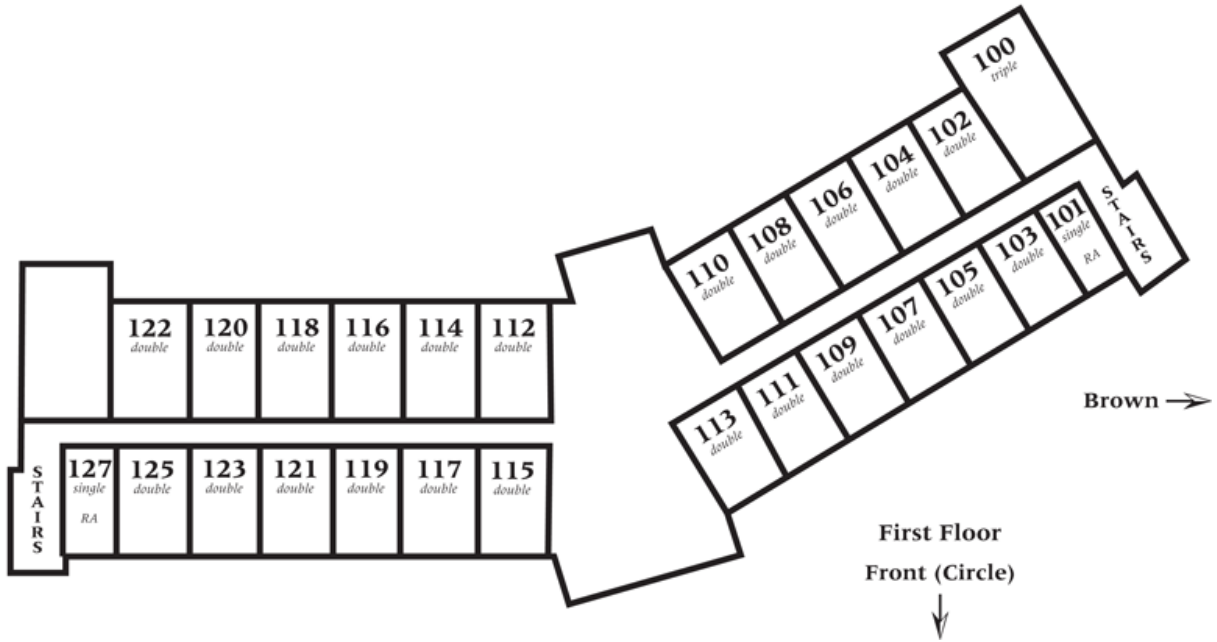

## TOLLEY HALL

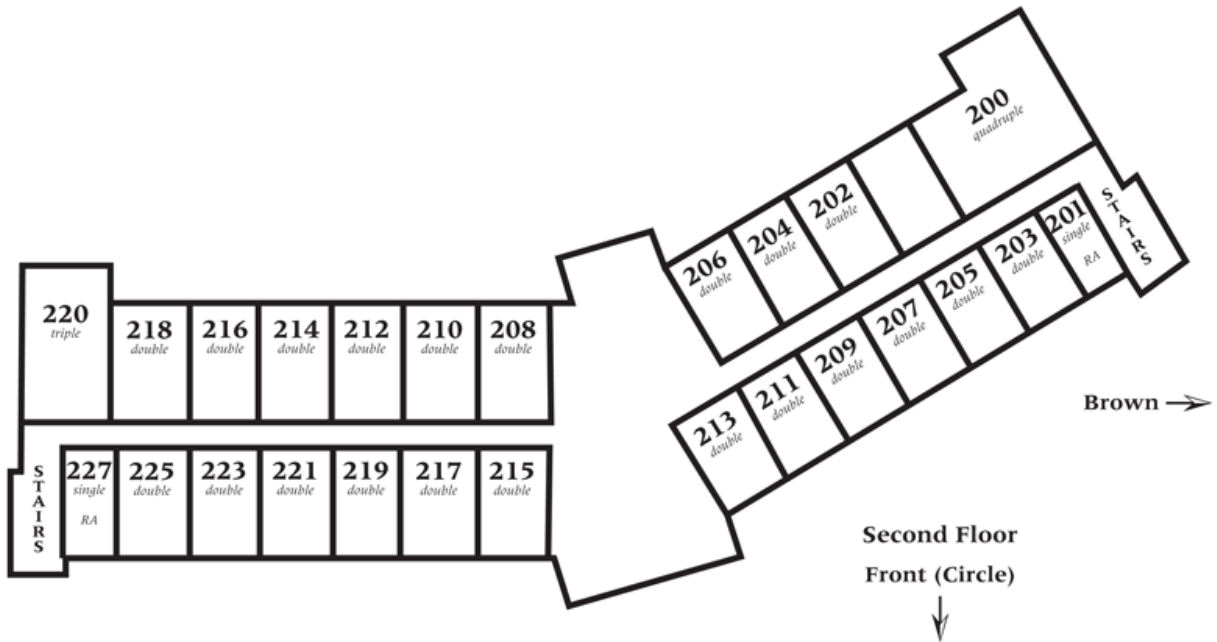

## Tolley/Brown Layouts & Hall Information

# TOLLEY HALL

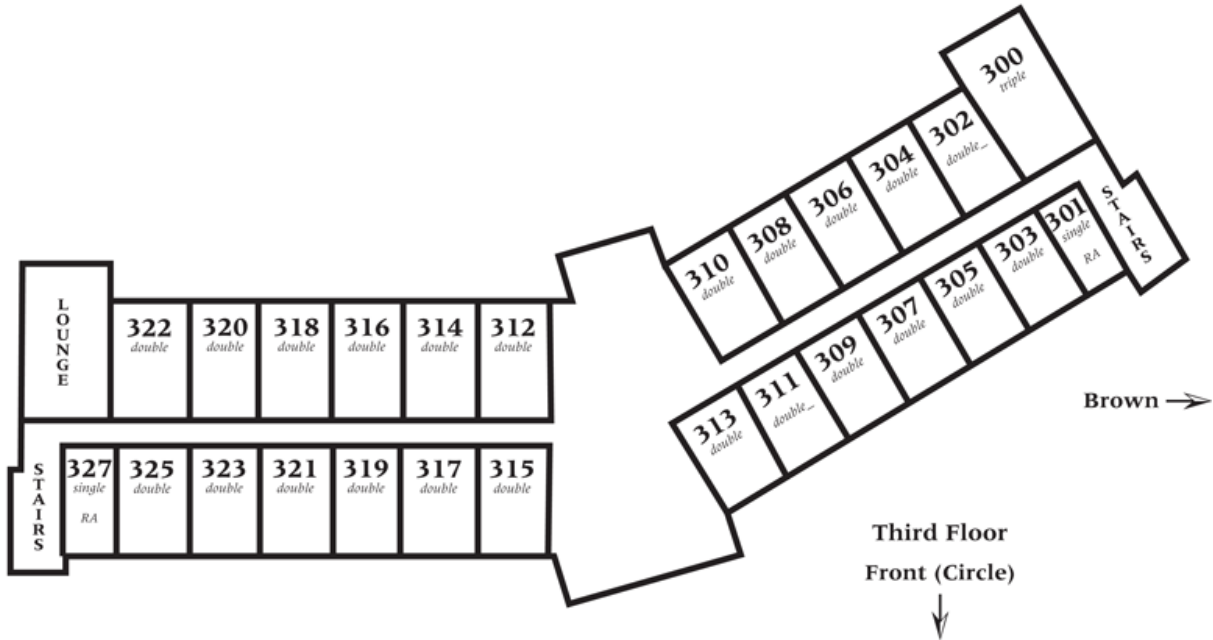

## Tolley Hall Facts:

Description	Capacity	Room Type	Room Size
Traditional Styled Co-Ed by room	153 Residents 5 Resident Assistants	66 Doubles 6 Singles 5 Triples 1 Quad	Single: 14'x8' Double: 14' x 10'6" Triple: 12'4"x20'6"
Window Size			
36" wide			
63" high			

# Tolley/Brown Layouts & Hall Information

## BROWN HALL

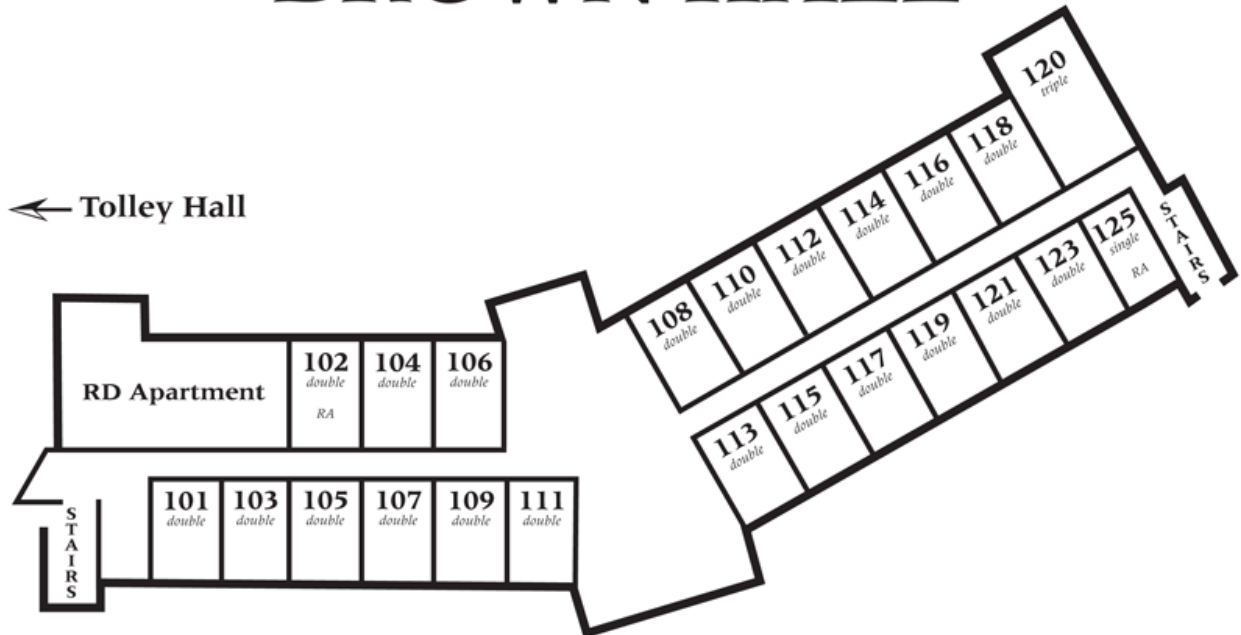

First Floor

Front Circle



## Tolley/Brown Layouts & Hall Information

# BROWN HALL

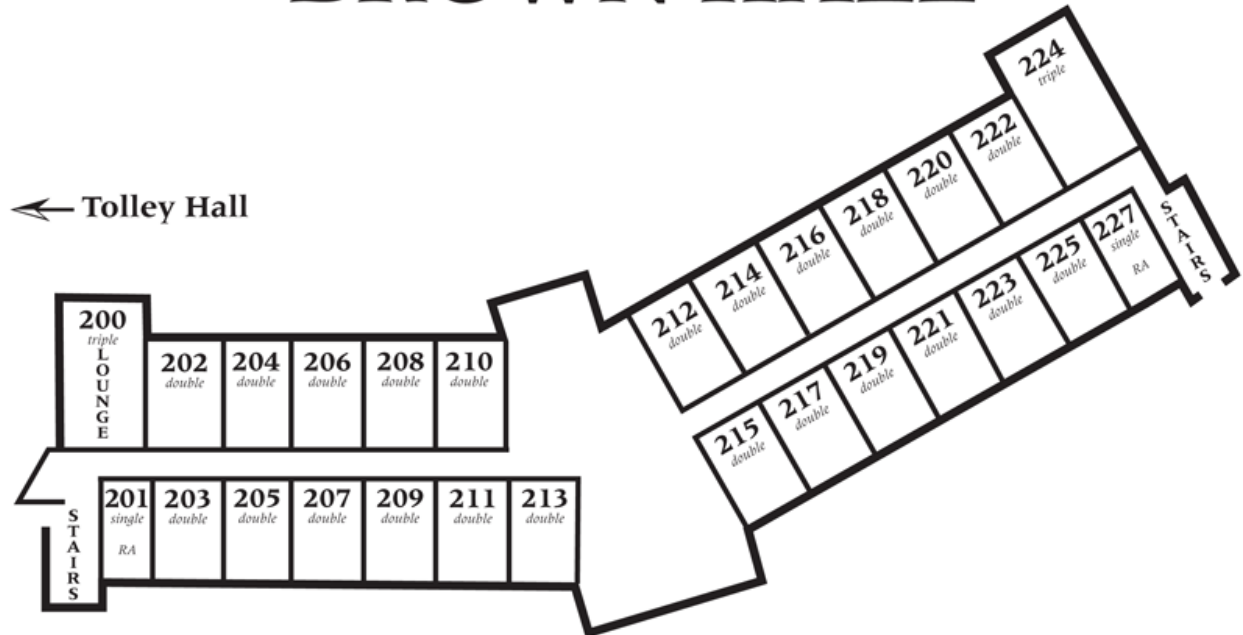

Second Floor

Front Circle



## Tolley/Brown Layouts & Hall Information

# BROWN HALL

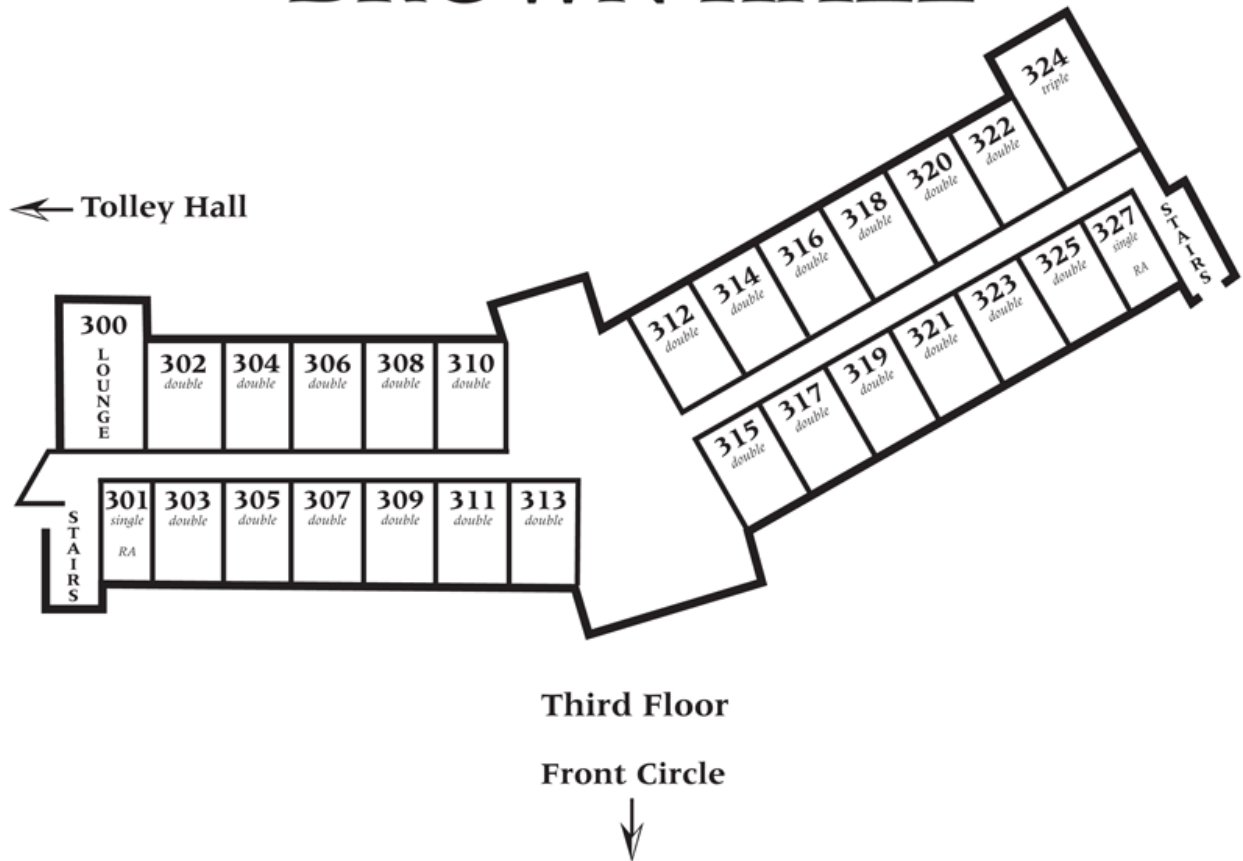

## Brown Hall Facts:

Description	Capacity	Room Type	Room Size
Traditional Styled Co-Ed by room	154 Residents 4 Resident Assistants	66 Doubles 5 Triples 1 Quad	Double: 14' x 10'6" Triple: 12'4"x20'6"

### Window Size

36" wide  
63" high