

Green Facts of McLendon Hall

- **Heat Island Reduction** – traditional roof material absorbs sunlight and generates a “heat island” which has detrimental affects on the natural surroundings. In McLendon Hall, highly reflective material was utilized to deflect the sunlight therefore reduce the absorption.
- **Improved Hardscape/Landscape** – the site surrounding the new construction provides heat island reduction through native plantings that will provide shade cover for the space of up to 50% within 5 years. Non-heat absorbing materials were also installed for sidewalks and other impervious surfaces.
- **Water Efficiency** – water efficiency is a key element of sustainable buildings. The new building has the following sustainable elements:
 - **Water Efficient Landscaping** – native vegetation and irrigation strategies reduce potable water use by 50% compared to local benchmarks.
 - **Non-Potable Irrigation** – rainwater and other recycled water are utilized to irrigate the site.
 - **Water Efficient Fixtures** – showers, faucets, toilets, and other plumbing fixtures exceed the Energy Policy Act of 1992 by at least 20%.
- **Energy Consumption Reduction** – energy use in the building has the most impact on the environment. Occupancy sensors, windows, and primary building heating systems were designed to operate with significantly greater efficiency than other dormitory facilities of like use. [The single biggest sustainable feature is the geothermal system.](#) This building uses this renewable energy to more effectively control the building’s temperature.
- **Recycled Construction Materials** – at least 10% of all material used to build McLendon Hall contained recycled materials, such as plastics, insulation, metal, and glass.
- **Low Emissions Paint and Coatings** – An overall reduction of indoor air contaminants was achieved by using paints and other surface coverings made from low emission materials.
- **Sustainable Operations** – low environmental impact cleaning products are being utilized to care for the space.

McLENDON HALL

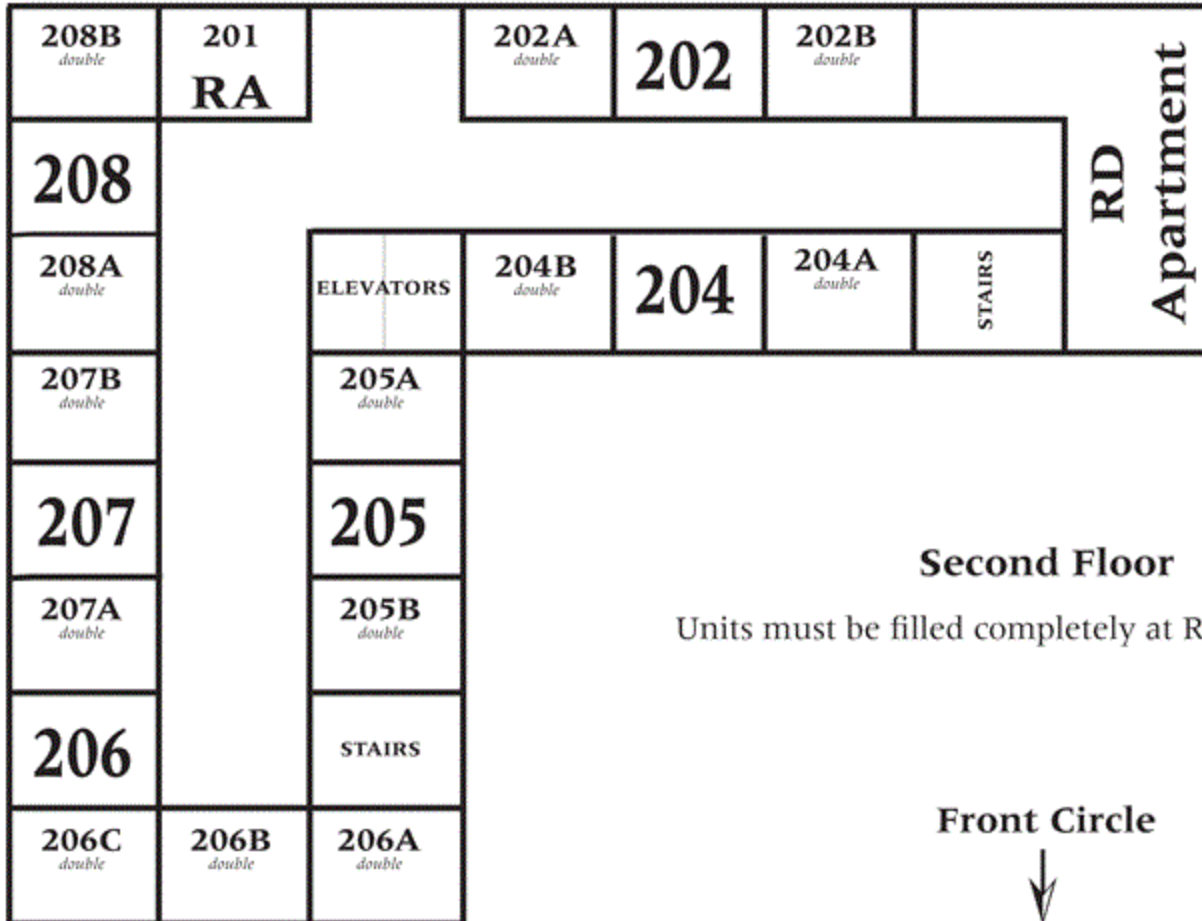

McClintock →

Second Floor

Units must be filled completely at Room Selection

Front Circle



McLENDON HALL

308B <i>double</i>	301 RA		302A <i>double</i>	302	302B <i>double</i>	303	303A <i>double</i>
308							303B <i>double</i>
308A <i>double</i>		ELEVATORS	304B <i>double</i>	304	304A <i>double</i>	STAIRS	303C <i>double</i>
307B <i>double</i>		305A <i>double</i>					
307		305					
307A <i>double</i>		305B <i>double</i>					
306		STAIRS					
306C <i>double</i>	306B <i>double</i>	306A <i>double</i>					

McClintock →

Third Floor

Units must be filled completely at Room Selection

Front Circle



McLENDON HALL

408B <i>double</i>	401 RA		402A <i>double</i>	402	402B <i>double</i>	403	403A <i>double</i>
408							403B <i>double</i>
408A <i>double</i>		ELEVATORS	404B <i>double</i>	404	404A <i>double</i>	STAIRS	403C <i>double</i>
407B <i>double</i>		405A <i>double</i>					
407		405					
407A <i>double</i>		405B <i>double</i>					
406		STAIRS					
406C <i>double</i>	406B <i>double</i>	406A <i>double</i>					

McClintock →

Fourth Floor

Units must be filled completely at Room Selection

Front Circle



McLENDON HALL

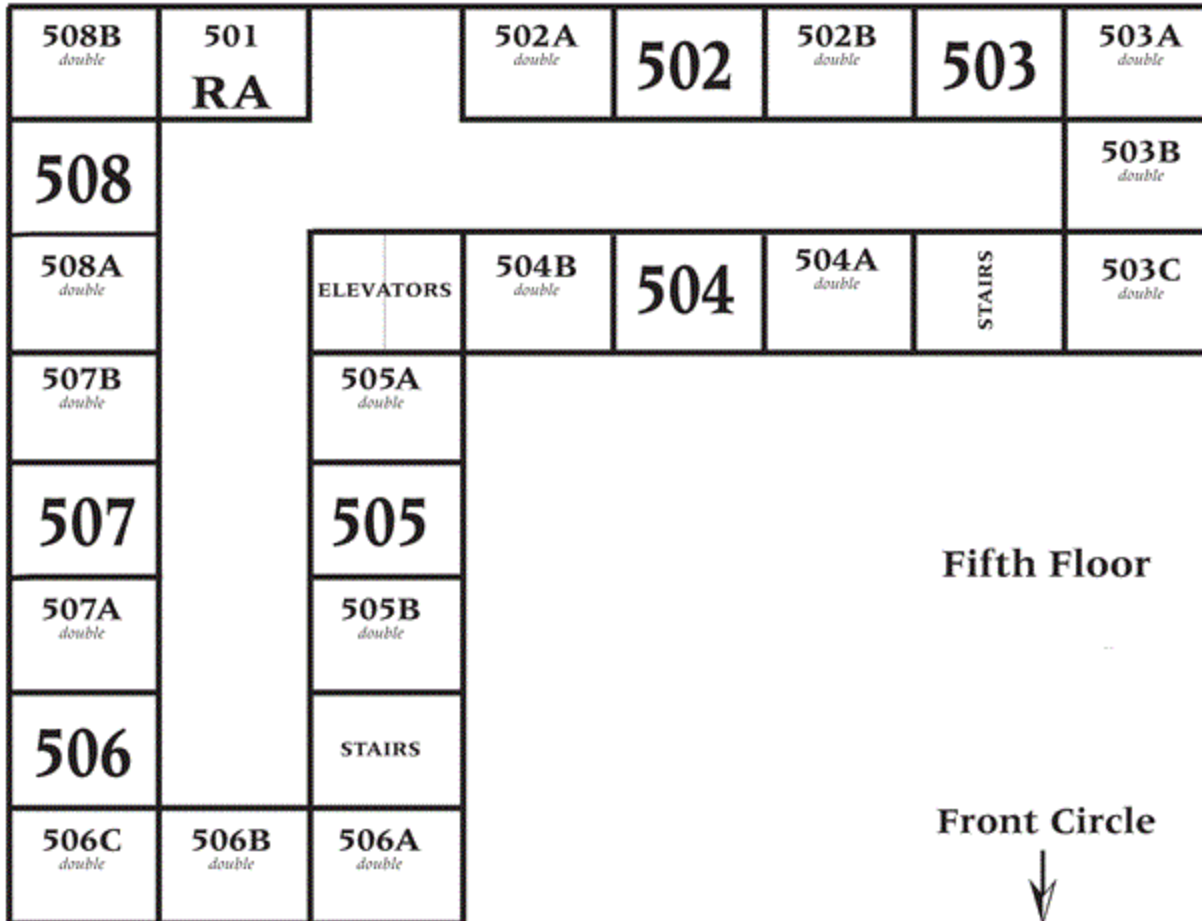

McClintock →

Fifth Floor

Front Circle



McLENDON HALL

608B <i>double</i>	601 RA		602A <i>double</i>	602	602B <i>double</i>	603	603A <i>double</i>
608							603B <i>double</i>
608A <i>double</i>		ELEVATORS	604B <i>double</i>	604	604A	STAIRS	603C <i>double</i>
607B <i>double</i>		605A <i>double</i>					
607		605					
607A <i>double</i>		605B <i>double</i>					
606		STAIRS					
606C <i>double</i>	606B <i>double</i>	606A <i>double</i>					

McClintock →

Sixth Floor

Rooms selected individually at room selection

Front Circle

