

McClintock Hall Facts:

Description	Capacity	Room Type	Room Size	Window Size
Suite Style Building Co-Ed by Suite	65 Residents	54 Doubles 2 Singles 1 Triple	11'6"x13' (<i>Approximately</i>)	56" wide 80" high (<i>Approximately</i>)

McCLINTOCK HALL

Each unit must be filled completely at room selection.

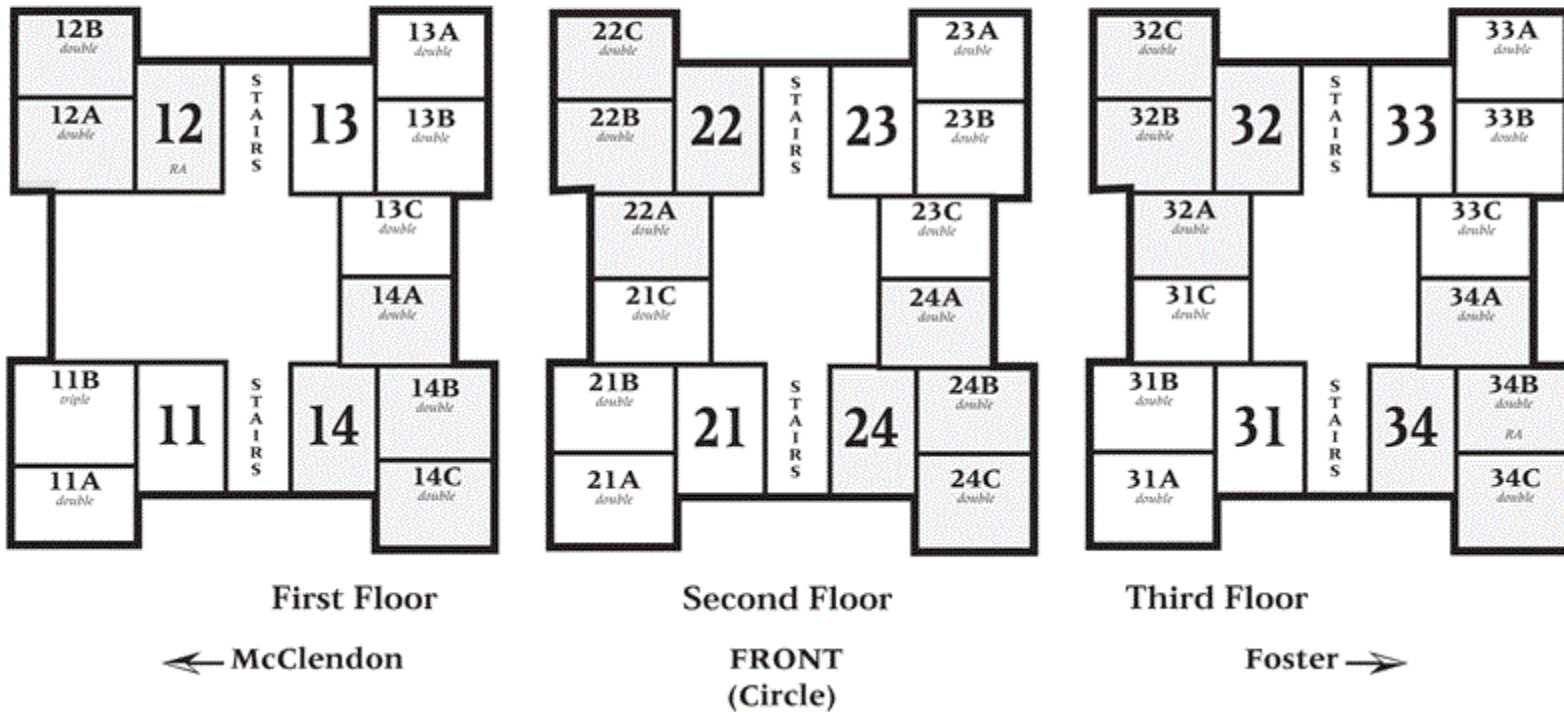

Other Information

- Common Room & Bathroom per suite
- Houses washer, dryer, and microwave
- Garbage shed located behind Complex